

2005 High Plains

June 18-25

Regional Rendezvous

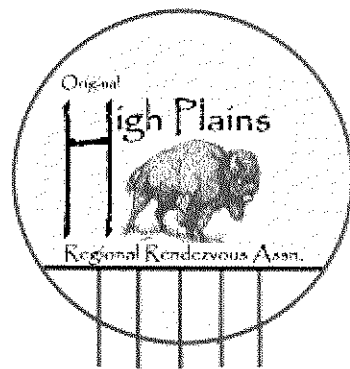

Not affiliated with the NMLRA
www.hprrr.org

Nestled among glorious shade trees along a babbling brook, come relive the Fur Trade Era in South Dakota!

Maps and registration information on back



Opening Ceremony June 19, 7:00pm

Closing Ceremony June 25, 11:00am

Long Term closes 6:30pm June 19

**Open to the Public June 18-19:
10:00am-5:00pm**

**Short Term hours June 20-25:
8:00am-9:00am & 4:00pm-5:00pm**



Come, sit a spell and enjoy Seminars, Demonstrations, Auctions, and other Entertainment, or just ol' fashioned Fur Trade hospitality.

Pre-1840 Attire and Lodging (in primitive camps) required.

Partake in demonstrations like brain tanning, bead or quillwork, scrimshaw, blacksmithing, flint knapping, or even pipe making with artisans there to lead you.

Prove yourself a Curly Wolf or simply show you're a Flash-In-The-Pan with Shooting, Hawk & Knife, Cooking, Archery, and other Games for Young & Old!

**Long, Short, and Tin Tipi camps available.
Wood, Water, Hooters, and Showers on site. Grocery runs daily.**

Early set-up available, no additional fee – Contact Booshway.

Pets, animal parts, etc must be cleared with SD Game, Fish, & Parks (605-882-5200) &/or Animal Industry Board (605-773-3321). Call for current state rules & regulations before entering South Dakota.

Travel Information

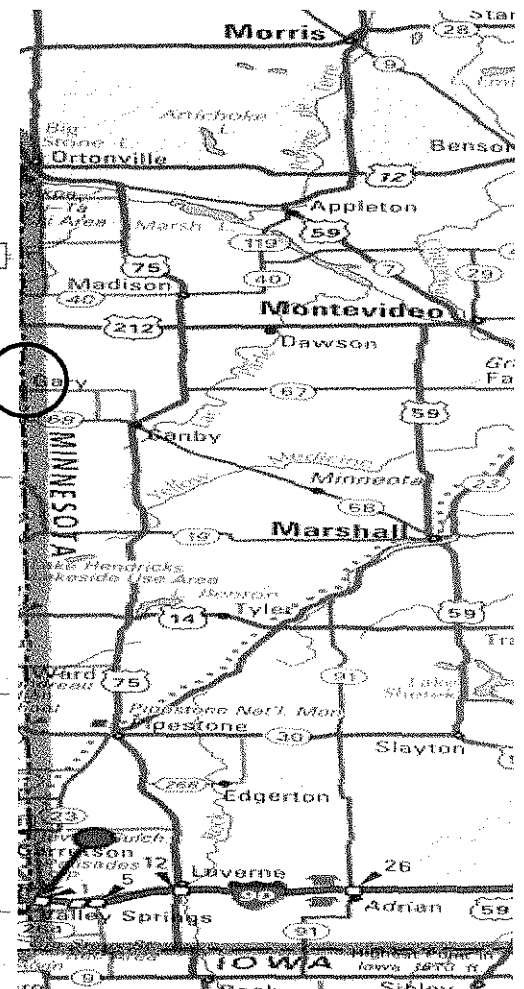
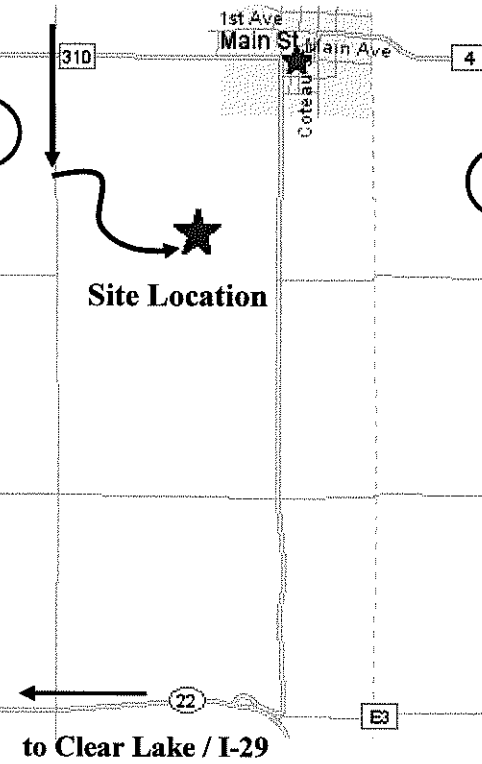
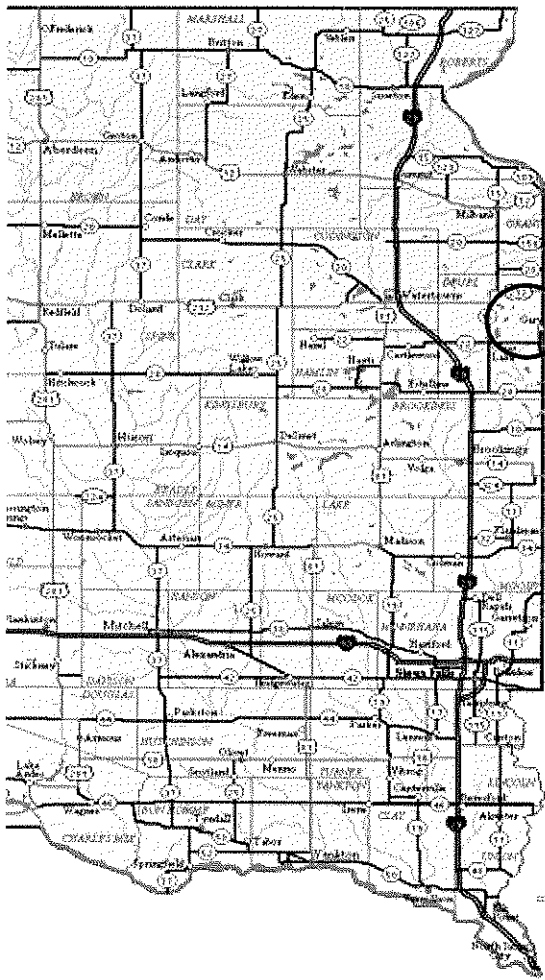

From Sioux Falls, SD 110 miles
From Fargo, ND 165 miles
From Topeka, KS 505 miles
From Billings, MT 765 miles

Mileage:

From Rapid City, SD 440 miles
From Minneapolis, MN 175 miles
From Omaha, NE 285 miles
From De Moines, IA 425 miles

2005 HPRR Contact Information

Booshway:
 Thane "No Shadow" Wells 605-874-2940 twells@itctel.com
Segundo:
 Tod "ManyLights" Wells 605-693-4440
Clerk:
 Mike Thelen 651-253-9012 aotiel@comcast.net

**Deuel County Sheriff's Office is point of contact for all outside emergencies:
 605-874-8212**

**Send completed Pre-Registration forms to: HPRR c/o Mike Thelen
 PO Box 18264
 Minneapolis, MN 55418**

{No Pre-Registration forms accepted after May 16, 2005}

Detach along dotted line

Name: _____ **Address:** _____
City, State, Zip: _____ **E-Mail:** _____
Phone: _____ **Volunteer** **Medical** **Range:** **Other:**
 :
Emergency **Emergency**
Contact: _____ **Phone:** _____

I would like to try my hand in the following demonstrations:

Camp Fee: includes 1 Medallion (2 Adults & Children under 18, 2 structure maximum)	@ \$35.00 (\$40.00 at Gate)	\$ _____
Additional Structure(s):	@ \$10.00 ea (\$15.00 ea at Gate)	\$ _____
Additional Adult per Camp {Medallion not included}	@ \$15.00 ea	\$ _____
Trader Fee: Includes 1 Camp & 1 Trade Tent	@ \$60.00 (\$65.00 at Gate)	\$ _____
Additional Medallion(s):	@ \$7.50 ea	\$ _____
{May not be available at Gate}		
Total Fee Due:		\$ _____